

FORM NO 1.

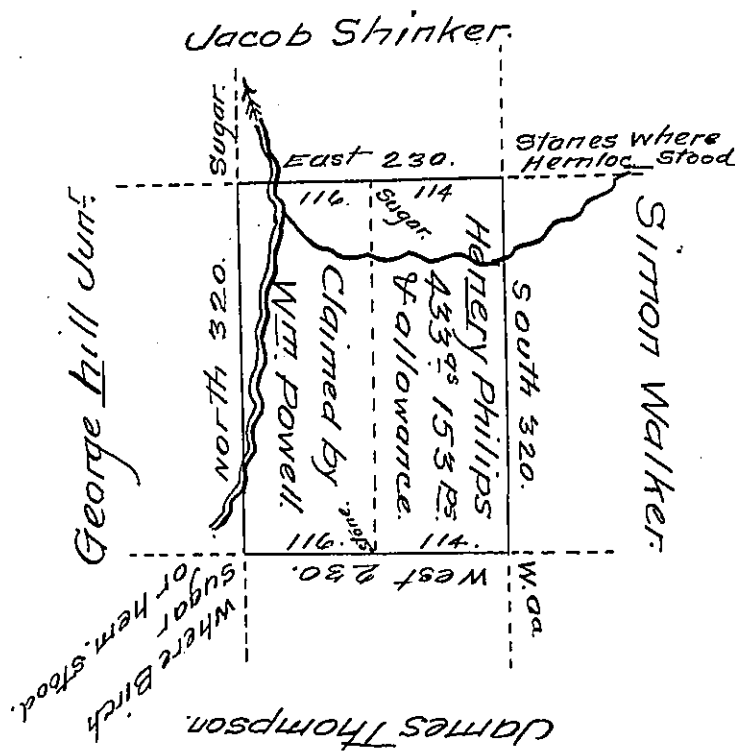

Situate on Clearfield Creek in White Township
Cambria County Survey'd April the 14th 1798 on war-
rent Dated the 15th March 1798 containing four hundred &
thirty three acres & one hundred & fifty three perches
with the usual allowance of six per cent. Resurvey'd
the 15th Day of April 1850 in pursuance of an order
of the Board of Property Dated the 9th Day of Feb
1850.

To the Honourable John Laporte THOS. McCONNELL D.S.

Surveyor General.

Wm. Powell claims the west side of the above sur-
vey as far as the Dotted line.

IN TESTIMONY that the above is a copy of the original remaining on file in
the Department of Internal Affairs of Pennsylvania, made
conformably to an Act of Assembly approved the 16th day of
February, 1833, I have hereunto set my Hand and caused
the Seal of said Department to be affixed at Harrisburg,
this Twelfth day of November 1907.

Henry Houck

Secretary of Internal Affairs.